

# dimension sheet MF-1, MF-2 and MF-3

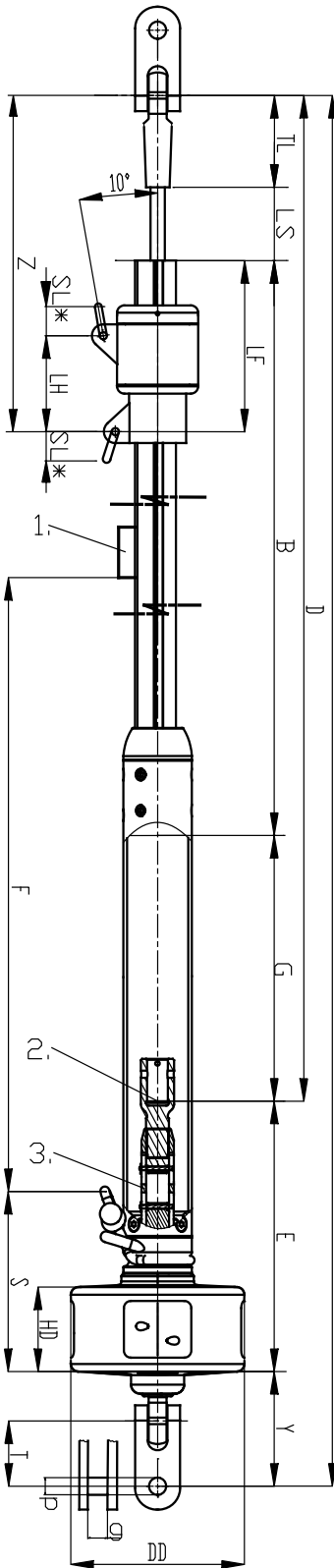

		MF-1						MF-2						MF-3		
halyard swivel / Fallenschlitten		FS-1			FS-2			FS-2			FS-3			FS-4		
foil size / Profilgröße		R10			R20			R20			R30			R40		
wire / Draht	[mm]	6	7	8	8	10	-	10	-	12	14	-	14	16	-	
rod / Rod	[-]	-8	-10	-12	-12	-17	-22	-17	-22	-22	-30	-40	-30	-40	-48	
T	pin - pin [mm]	64						72						93		
p	[mm]	12,7			15,9			19,1			22,2			25,4		
g	[mm]	17,5						24						28		
TL	[mm]	length of installed top terminal / Länge des installierten Topterminals														
LS	[mm]	70						70						120		
LF	[mm]	260			280			280			320			370		
LH	[mm]	135			145			145			180			200		
SL ***	[mm]	25			35			35			35			55		
Z	[mm]	dependent on TL / abhängig von TL														
S	[mm]	170						200						275		
F	[mm]	1160						1200						1310		
G *	rod / Rod [mm]	140						172						235		
	wire / Draht [mm]	138 (ø6; ø7; ø8); 126 (ø10)						159 (ø10); 164 (ø12); 152 (ø14)						218		
E *	rod / Rod [mm]	272						305						420		
	wire / Draht [mm]	274 (ø6; ø7; ø8); 286 (ø10)						318 (ø10); 313 (ø12); 325 (ø14)						437		
stroke / Hub	turnbuckle / Spanner [mm]	60						60						80		
Y **	min. [mm]	100						117						148		
adjustment / Verstellweg	toggle eye / Toggelaug [mm]	65						66						72		
DD	[mm]	167						193						260		
HD	[mm]	86						94						130		

\* turnbuckle in mid position / Spanner in Mittelposition

\*\* toggle eye fully in / Toggelaug ganz eingeschraubt

\*\*\* Wichard D-shackle on FS-1, FS-2, FS-3, FS-4 / Wichard D-Schäkel an FS-1, FS-2, FS-3, FS-4

## Aluminium profiles:

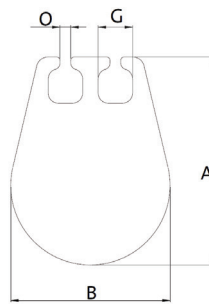

size	groove	G (mm)	O (mm)	A (mm)	B (mm)
R10	double	6,4	2,3	31,4	24,1
R20	double	6,4	2,3	35,8	28,8
R30	double	7,5	3,0	45,5	36,1
R40	double	7,5	3,0	49,1	38,7
R50	double	8,0	3,5	54,0	42,0

1. sail feeder / Segeleinfuehrer
2. lower end rod head/swage terminal  
Unterkante Rodkopf/Walzterminal
3. turnbuckle mid position / Spanner Mittelposition